



COMMERCIAL

Refrigeration Equipment 4-Drawer Mega Top Prep Table 48" Long 18-1/6 Pan

ITEM # _____

MODEL # _____

NAME # _____

SIS # _____

AIA # _____



738287 (KCHMT48.18.2D)

4-Drawer Mega Top Prep
Table 48" Long 18-1/6 Pan

Short Form Specification

Item No. _____

4-drawer mega top refrigerated preparation table. Exterior back panel in aluminum, exterior bottom panel in galvanized steel, exterior side and top panel in 430 stainless steel; interior back, top and interior bottom panels in 304 stainless steel, worktop in 430 stainless steel.

Built-in refrigeration unit and an insulated lid to maintain food freshness. Fin & Tube Condenser improves performance in high-temperature environments. Automatic Defrost Cooling System to provide worry-free performances.

Full-depth cutting board 71x9x0.5 in.

Control panel, Vinyl-Coated Steel adjustable shelves, removable door gaskets and self-closing doors with 90-degree stay-open feature.

Temperature range: +33/+41°F.

R290 gas in the refrigeration circuit.

ETL Safety and Sanitation certifications.

3/5 Years warranty.

Main Features

- Removable gasket for easy cleaning operations.
- Hydrocarbon refrigerant gas R290 for the lowest environmental impact (GWP=3) - CFC and HCFC free.
- Fin & Tube Condenser improves performance in high temperature environments.
- Automatic Defrost Cooling System provides worry-free performance.
- Electronic Temperature Control, quick and simple to set, with control display for easy monitoring.
- Full Depth cutting board.
- External temperature display.
- Cabinet completely insulated with high density polyurethane for low environmental impact.
- Heavy duty Vinyl coated steel shelves.

Construction

- Self-closing door with 90-degree stay-open feature.
- Heavy duty casters.
- Insulated lid maintains food freshness.
- Pre-wired heavy duty power cord.
- Heavy duty door hinges.
- Magnetic gasket removable without tools for easy cleaning.

Sustainability

- CFC and HCFC free, highly ecological refrigerant type: R290 (ecological gas in foam: cyclopentane). Hydrocarbon refrigerant gas R290 for the lowest environmental impact (GWP=3), to reduce green house and ozone depletion effects.
- High efficiency components to minimize the energy consumption still guaranteeing the highest performances.

Optional Accessories

- shelf for 48" and 72" (left/right) mega top, salad and undercounter PNC 880597 ☐
- shelf clips PNC 880611 ☐

APPROVAL: _____

Part of



Electrolux
Professional
Group

Kelvinator Commercial
www.kelvinatorcommercial.com

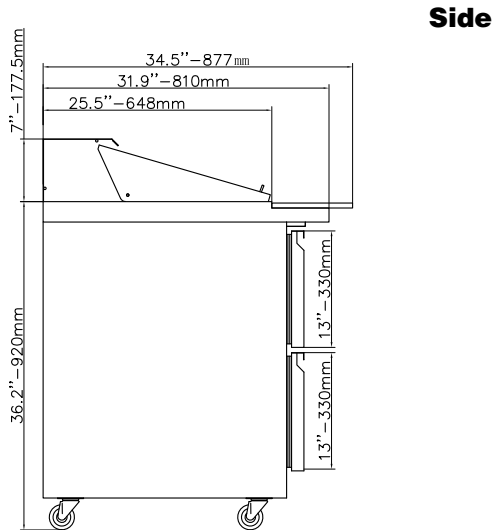
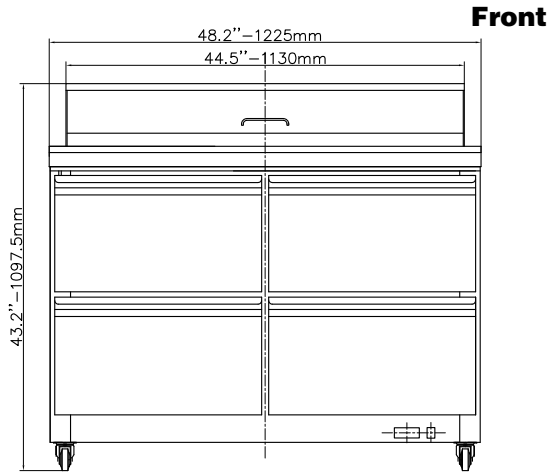

EI = Electrical connection

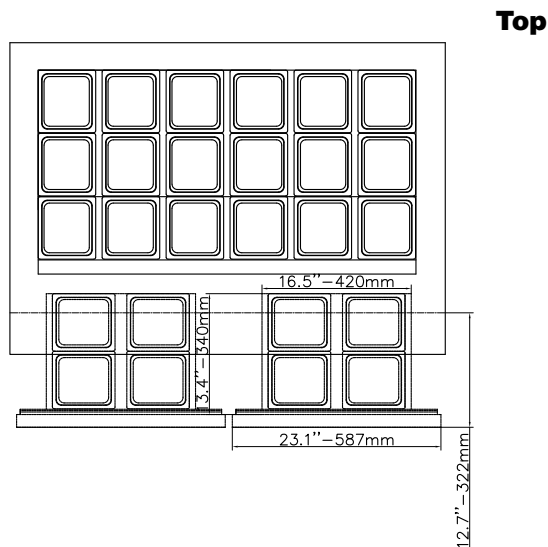

Electric

Supply voltage:

738287 (KCHMT48.18.2D) 115 V/1 ph/60 Hz

Electrical power, max:

0.7 kW

Plug type:

USA NEMA 5-15P

Capacity:

Gross capacity: 12 cu.feet

Key Information:

| | |
|--------------------------------------|------------------------|
| External dimensions, Width: | 48 1/4" (1225 mm) |
| External dimensions, Depth: | 34 1/2" (877 mm) |
| External dimensions, Height: | 43 3/16" (1097.5 mm) |
| Number and type of doors: | |
| Internal Dimensions (depth): | 23 13/16" |
| Internal Dimensions (height): | 23 1/2" |
| Internal Dimensions (width): | 42 13/16" |
| Shipping height: | 47 1/4" (1200 mm) |
| Shipping weight: | 320 lbs (145 kg) |
| Number and type of grids (included): | 1 - Vinyl-Coated Steel |
| Type of external material: | Stainless Steel |
| Type of internal material: | 304 AISI |
| Warranty: | 3 / 5 years |

Refrigeration Data

| | |
|-----------------------------|--------------|
| Compressor power: | |
| Operating temperature min.: | 32 °F |
| Operating temperature max.: | 41 °F |
| Condenser type: | Fin & tube |
| Defrost type: | Auto Defrost |

Sustainability

| | |
|----------------------|--------|
| Current consumption: | 7 Amps |
| Refrigerant type: | R290 |
| Refrigerant weight: | 90 g |